

WIRELESS DIMMING SOCKET

EN

(LUXURY VERSION)



Combination of iNELS wall-mounted wireless controller and wireless dimming socket for regulation of all types of dimmable bulbs and light sources.

Content



Glass touch controller - 4 buttons, SHARP RFGB-40/W, RFGB-40/B



Glass touch controller - 4 buttons, ROUND RFGB-240/W, RFGB-240/B



Schuko



British



French

Dimming socket-plug RFDSC-71N

Design

- EAN 8595788183277 (Glass touch controller - 4 buttons, SHARP, black + Dimming socket-plug "French")
EAN 8595788183284 (Glass touch controller - 4 buttons, SHARP white + Dimming socket-plug "French")
EAN 8595788183291 (Glass touch controller - 4 buttons, ROUND, black + Dimming socket-plug "French")
EAN 8595788183307 (Glass touch controller - 4 buttons, ROUND, white + Dimming socket-plug "French")
EAN 8595788183376 (Glass touch controller - 4 buttons, SHARP, black + Dimming socket-plug "British")
EAN 8595788183383 (Glass touch controller - 4 buttons, SHARP, white + Dimming socket-plug "British")
EAN 8595788183390 (Glass touch controller - 4 buttons, ROUND, black + Dimming socket-plug "British")
EAN 8595788183406 (Glass touch controller - 4 buttons, ROUND, white + Dimming socket-plug "British")
EAN 8595788183475 (Glass touch controller - 4 buttons, SHARP, black + Dimming socket-plug "Schuko")
EAN 8595788183482 (Glass touch controller - 4 buttons, SHARP, white + Dimming socket-plug "Schuko")
EAN 8595788183499 (Glass touch controller - 4 buttons, ROUND, black + Dimming socket-plug "Schuko")
EAN 8595788183505 (Glass touch controller - 4 buttons, ROUND, white + Dimming socket-plug "Schuko")

The individual **elements in the iNELS** set are paired and their **functions are preset**.
iNELS kit wireless switch enables the basic function of controlling electrical appliances - **ON / OFF**.

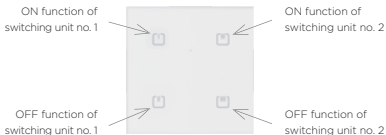

The settings of the wall controllers can be changed - detailed manual on the next pages.



Glass touch controller - 4 buttons, SHARP/ROUND, RFGB-40/RFGB-240

Detailed manual



RFGB-40



RFGB-240

- RFGB-40/B - glass touch controller, SHARP - black, 4-buttons
- RFGB-40/W - glass touch controller, SHARP - white, 4-buttons
- RFGB-240/B - glass touch controller, ROUND - black, 4-buttons
- RFGB-240/W - glass touch controller, ROUND - white, 4-buttons

Characteristics

- The wireless control - used to control, lights, gate, garage door, shutters, etc.
- Thickness only 8 mm.
- 4 capacitive buttons allows you to control 4 components.
- Fast installation on any surface - the rear base allows screwing to the walls, gluing with double-sided tape or just laying on the table.

Replacement of a battery in 3 steps

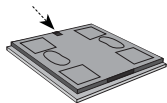

Press to open the plug-in battery holder
(you can use a flat-blade screwdriver
to open it).

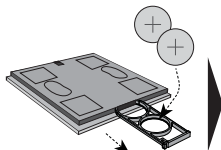

Insert the CR2032 battery into Battery
holder. Watch out for polarity.

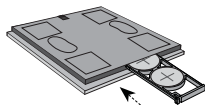

Insert the holder into
the device.

Assembly

Adhesive

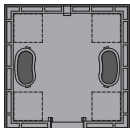

Peel off one protective layer on the double-sided adhesive sheets and stick them to the marked places on the controller.

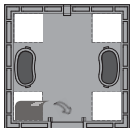

Peel off the second protective layer on the double-sided adhesive sheets and place the control in the prepared place.

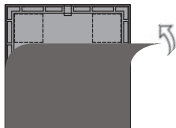

If the device is installed on glass, cover it with a cover foil.

In the installation box or on the wall

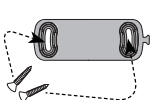

Mount the snap bar on the controller into the installation box or on the wall.

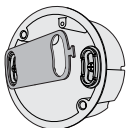

Place the mounting jig on the KU box and screw it on.



Snap on the controller.

Technical parameters**RFGB-40/RFGB-240**

Power voltage:	2x 3 V battery CR 2032
Battery life:	about 2 years depending on the frequency of use
Transmission indication	Red LED
Number of capacitive buttons:	4
Communication Protocol:	RFIO
Frequency:	868.5 MHz
Signal transmission method:	one-way addressed message
Range:	in the open up to 200 m
Material:	Glass
Other data	
Operating Temperature:	-10 ... +50 °C (14 ... 122 °F)
Working Position	any
Mounting:	adhesive, screw
Protection	IP20
Pollution degree:	2
Dimension:	SHARP 94 x 94 x 8 mm (3.7" x 3.7" x 0.3") / ROUND 100 x 100 x 8 mm (3.9" x 3.9" x 0.3")
Weight:	SHARP 107 g/ ROUND 108 g
Related standards:	EN 60669, EN 300 220, EN 301 489



Dimming socket plug RFDSC-71N

Detailed manual



RFDSC-71N

Characteristics

- used to control light sources that are connected by power cord - especially lamps:
R, L, C, ESL, LED - LED light sources (230V).
- Be combined with detectors, controllers, iNELS RF Control or system components.
- Installation is simple by direct insertion into the existing socket.
- Output load 200 W.
- Multi-function 6 light functions - smooth increase or decrease with time setting 2 s-30 min.
- When switched off, the set level is stored in the memory, and when switched back on, it returns to the most recently set value.
- The universal dimmer may be controlled by up to 32 channels (1 channel represents 1 button on the controller).
- The programming button on the socket is also used for manual control of the output.
- Memory status can be pre-set in the event of a power failure.
- Range up to 160 m (in open space), if the signal is insufficient between the controller and unit,
- use the signal repeater RFRP-20 or protocol component RFIO2 that support this feature.

Assembly

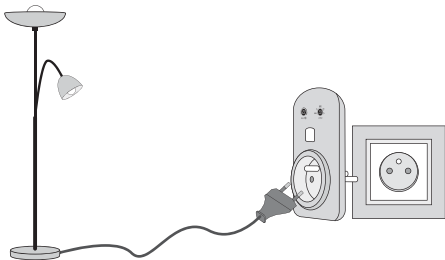

Technical parameters**RFDSC-71N**

Supply voltage:	230 V / 50-60Hz
Apparent power:	1.1 VA
Dissipated power:	0.8 W
Supply voltage tolerance:	+10 %; -15 %
Output:	
Contactless:	2 x MOSFET
Load capacity:	200 W *
Control:	
RF command from the transmitter:	868.5 MHz
Range in open space:	up to 160 m
Manual control:	button PROG (ON/OFF)
Other data:	
Operating temperature:	-20 ... + 35 °C (-4 ... + 95 °F)
Storage temperature:	-30 ... +70°C (-22 ... + 158 °F)
Working position:	any
Mounting:	plug into a socket
Protection:	IP30
Overvoltage category:	III.
Contamination degree:	2
Dimensions:	63 x 110 x 74 mm
Weight:	118 g
Related standards:	EN 60730, EN63044, EN 300 220, EN 301 489

* capacity for power factor $\cos \varphi=1$

The power factor of dimmable LEDs and ESL bulbs ranges from:

$\cos \varphi = 0.95$ up to 0.4.

Compatibility





The device can be combined with all system components, controls and devices of iNELS RF Control and iNELS RF Control2.

The detector can be assigned an iNELS RF Control2 (RFIO2) communication protocol.

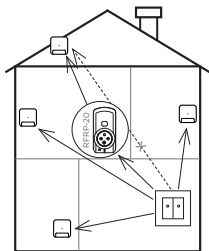
Radiofrequency signal penetration through various construction materials

Range up to 160 m in open space,



				
60 - 90 %	80 - 95 %	20 - 60 %	0 - 10 %	80- 90 %
brick walls	wooden structures with plaster boards	reinforced concrete	metal partitions	common glass

Warning

Instruction manual is designated for mounting and also for the usage of the device. It is always a part of its packing. Installation and connection can be carried out only by a person with adequate professional qualification with understanding this instruction manual and functions of the device, and while observing all valid regulations. Trouble-free function of the device also depends on transportation, storing and handling. In case you notice any sign of damage, deformation, malfunction or missing part, do not install this device and return it to its seller. It is necessary to treat this product and its parts as electronic waste after its lifetime is terminated. Before starting installation, make sure that all wires, connected parts or terminals are de-energized. While mounting and servicing observe safety regulations, norms, directives and professional, and export regulations for working with electrical devices. Do not touch parts of the device that are energized - life threat. Due to transmissivity of RF signal, observe correct location of RF components in a building where the installation is taking place. RF Control is designated only for mounting in interiors. Devices are not designated for installation into exteriors and humid spaces. The must not be installed into metal switchboards and into plastic switchboards with metal door - transmissivity of RF signal is then impossible. RF Control is not recommended for pulleys etc. - radiofrequency signal can be shielded by an obstruction, interfered, battery of the transceiver can get flat etc. and thus disable remote control.

Designed & Manufactured by:

ELKO EP, s.r.o. Palackého 493, 769 01 Holešov, Všetuly,
Czech republic, www.elkoep.com, Hotline: +420 800 100 671

