

# WIRELESS SWITCH

EN

(CLASSIC VERSION)



Combination of iNELS wall-mounted wireless controller and switching unit for various uses. It can be used to for remote control electrical appliances, lights, sockets, garage doors, etc.

## Package

 On-wall button controller PLASTIC - 2 buttons  
RFBW-20/G

 On-wall button controller PLASTIC - 4 buttons  
RFBW-40/G

 Switch unit, 1-channel  
RFSAI-11B-SL

EAN 8595788182878 (On-wall button controller PLASTIC - 2 buttons + 1 switch unit, 1-channel)

EAN 8595188182881 (On-wall button controller PLASTIC - 4 buttons + 2 switch units, 1-channel)

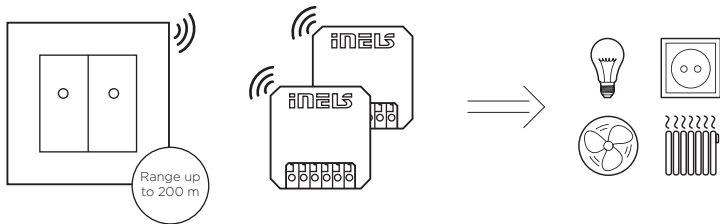

The individual **elements in the iNELS kit** are paired and their **functions are preset**.

iNELS kit wireless switch enables the basic function of controlling electrical appliances - **ON / OFF**.

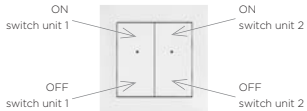
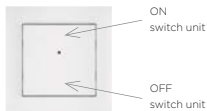

The settings of the wall controllers can be changed - see detailed manuals of iNELS elements.



## On-wall button controller RFWB-20/G, RFWB-40/G

Detailed manual



RFWB-20/G



RFWB-40/G

RFWB-20/G - On-wall button controller PLASTIC - 2 buttons

RFWB-40/G - On-wall button controller PLASTIC - 4 buttons

### Characteristics

- The wireless controller is used to control switches and dimmers (lights, gate, garage door, blinds, etc.).
- **RFWB-20/G:** two buttons enable control one or two units independently (depending on the type of switching element).
- **RFWB-40/G:** two buttons enable control from two up to four units independently (depending on the type of switching element).
- The flat design with level base makes it ideal for fast installation on any surface (fixation with adhesive or screws in the installation box).

### Battery replacement RFWB-20/RFWB-40

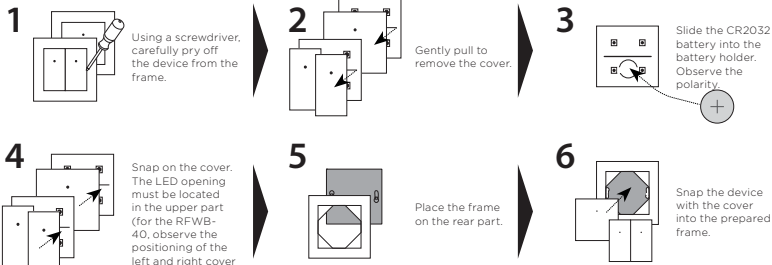

### Safe handling



When handling a device unboxed it is important to avoid contact with liquids. Never place the device on the conductive pads or objects, avoid unnecessary contact with the components of the device.

**Technical parametres****RFWB-20/G****RFWB-40/G**

Supply voltage:	3 V battery CR 2032	
Transmission indication:	red LED	
Number of buttons:	2	4
Transmitter frequency:	868.5 MHz	
Signal transmission method:	unidirectionally addressed message	
Range in free space:	up to 200 m	
<b>Other data</b>		
Operating temperature:	-10 ... +50 °C (14 ... 122 °F)	
Operating position:	any	
Mounting:	glue, screws	
Protection:	IP20	
Contamination degree:	2	
Dimensions:	85 x 85 x 16 mm (3.3" x 3.3" x 0.6")	
Weight:	38g * (1.34 oz)	39g * (1.37 oz)
Related standards:	EN 60669, EN 300220, EN 301489 R&TTE Directive,	

\* According to the territory - see the cabel.

**Attention:**

When you instal iNELS RF Control system, you have to keep minimal distance 1 cm between each units. Between the individual commands must be an interval of at least 1s.



# Switch unit, 1-channel RFAI-11B-SL

Detailed manual



RFAI-11B-SL

## Characteristics

- The switching unit with 1 output channel is used to control appliances, lights, etc.
- They can be combined with detectors, controllers, iNELS RF Control2 or system components.
- The BOX design lets you mount it right in an installation box, a ceiling or a controlled appliance cover.
- The switched load up to 8 A (2.000 W).
- Single-function design - switch on / off.
- The output on the switching unit can be controlled by up to 25 channels (1 channel represents one button on the controller).
- The programming button on the unit is also used for manual control of the output.
- Memory status can be pre-set in the event of a power failure.
- For components labeled as iNELS RF Control<sup>2</sup> (RFIO<sup>2</sup>), it is possible to set the repeater function via the RFAF/USB service device.
- Communication frequency with bidirectional protocol iNELS RF Control2 (RFIO2).

## Installation options

In to the installation box

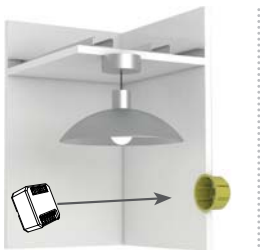

into the ceiling light cover



under ceiling mounted



**Technical parameters****RFSAI-11B-SL**

Supply voltage:	230 V AC
Supply voltage frequency:	50-60 Hz
Power apparent / dissipated:	7 VA / $\cos \varphi = 0.1$ / 0.7 W
<b>Output:</b>	
Number of contacts:	1x switching contacts (AgSnO2)
Rated current: / switching power	8 A / AC1 / 2000 VA
Peak current:	10 A / <3 s
Max. switching voltage:	250 V AC1
<b>Commuation:</b>	
Manual:	button PROG (ON/OFF)
Frequency:	868.5 MHz
<b>Other data:</b>	
Operating temperature:	-15 ... + 50 °C (5 ... 122 °F)
Mounting:	free at lead-in wires
Protection:	IP40
Overvoltage category:	III.
Dimensions:	43 x 44 x 22 mm (1.9" x 1.97" x 0.8")
Weight:	31 g
Related standards:	EN 60730, EN 63044, EN 300 220, EN 301 489

## Compatibility

The device can be combined with devices of iNELS RF Control2 with RFIO2 protocol.

## Connection

S - external input

N - neutral wire

L - phase wire

V - output

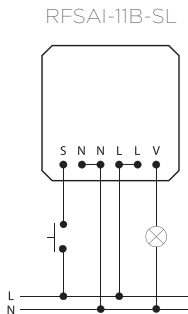

## Screwless terminals

i - programming button

- manual controll



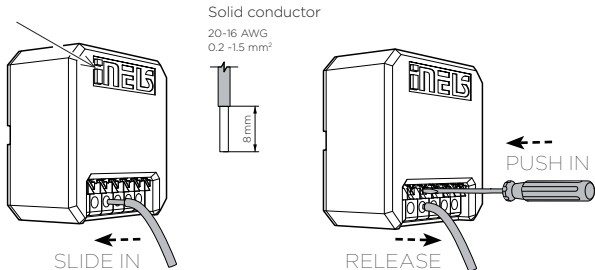

- output status indication

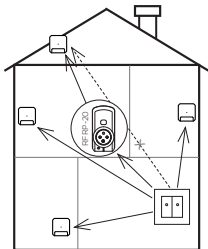

## Radiofrequency signal penetration through various construction materials

Range up to 200 m in open space, if the signal is insufficient between the controller and unit, use the signal repeater RFRP-20 or protocol component RFIO2 that supports this feature.

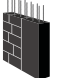

				
60 - 90 %	80 - 95 %	20 - 60 %	0 - 10 %	80- 90 %
brick walls	wooden structures with plaster boards	reinforced concrete	metal partitions	common glass

### Warning

Instruction manual is designated for mounting and also for the usage of the device. It is always a part of its packaging. Installation and connection can be carried out only by a person with adequate professional qualification with understanding this instruction manual and functions of the device, and while observing all valid regulations. Trouble-free function of the device also depends on transportation, storing and handling. In case you notice any sign of damage, deformation, malfunction or missing part, do not install this device and return it to its seller. It is necessary to treat this product and its parts as electronic waste after its lifetime is terminated. Before starting installation, make sure that all wires, connected parts or terminals are de-energized. While mounting and servicing observe safety regulations, norms, directives and professional, and export regulations for working with electrical devices. Do not touch parts of the device that are energized - life threat. Due to transmissivity of RF signal, observe correct location of RF components in a building where the installation is taking place. RF Control is designated only for mounting in interiors. Devices are not designated for installation into exteriors and humid spaces. The must not be installed into metal switchboards and into plastic switchboards with metal door - transmissivity of RF signal is then impossible. RF Control is not recommended for pulleys etc. - radio-frequency signal can be shielded by an obstruction, interfered, battery of the transceiver can get flat etc. and thus disable remote control.

Designed & Manufactured by:

ELKO EP, s.r.o. Palackého 493, 769 01 Holešov, Všetuly,  
Czech republic, [www.elkoep.com](http://www.elkoep.com), Hotline: +420 800 100 671

